

Screw Conveyor Hanger Bearings

OTHER SIZES AVAILABLE ON REQUEST.

DIMENSIONS				
A	B	C	D	E
1-1/2	2-3/16	2-1/2	1-7/8	1-9/16
2	2-3/4	3-1/8	1-15/16	1-9/16
2-7/16	3-1/4	3-11/16	2-15/16	2-3/8
3	4	4-3/8	2-15/16	2-1/4
3-7/16	4-3/4	5	3-3/16	3-1/16

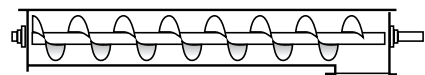

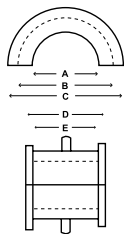



SCREW CONVEYOR

STYLE "A" BEARING: STYLE 226

Two-piece double flange bearing for screw conveyor hanger with formed strap. This hanger bearing is interchangeable with the following styles: 20A, 20B, 26B, 28A, 30, 50, 220, 226 228 and 326.

***HANGER STRAP NOT INCLUDED**

MAXI-LIFT HANGER BEARINGS	PLASTECH	WEARITE*	UHMW	WOOD
				
MATERIAL	Engineered nylon resin	Engineered nylon resin	Polyethylene	Maple
GRADE	Food grade, FDA	Industrial grade	Food grade, FDA	Industrial grade
METHOD OF MANUFACTURE	Injection molded	Injection molded	Machined or molded	Machined
TEMPERATURE OPERATING RANGE	-60°F to +300°F	-60°F to +300°F	-22°F to +180°F	-50°F to +160°F
LUBRICANT	Built-in lubricant	Built-in lubricant*	Natural	Oil impregnated
COLOR	Tan	Black	White	Brown

*Wearite bearings available drilled and tapped for lubing or purging pipes at additional cost.

STYLE "B" BEARING: STYLE 18B

Cap type half bearing for screw conveyor hanger with U-bolt construction. Hanger Styles 17, 18, 18A, 18B, 19B and 40. Available in wood and UHMW.

***HANGER STRAP NOT INCLUDED**

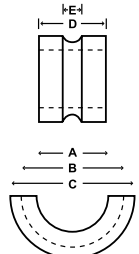

DIMENSIONS				
A	B	C	D	E
3	3-7/8	4-13/16	2-7/8	13/16
3-7/16	4-7/16	5-3/8	3-13/16	7/8

STYLE "C" BEARING: STYLE 216

Two piece bearing with rectangular upper half and double flange lower half for Hanger Styles 16, 16B, 16C, 24, 24A, 24B, 28, 216, 216B, 216C, 216F, 230 and 316. Available in wood and UHMW. Call for sizes and dimensions.

***HANGER STRAP NOT INCLUDED**

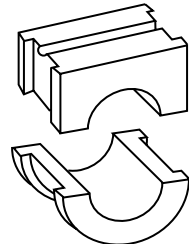

Call: 1-800-527-0657 or Visit Us Online at: www.maxilift.com

16400 Midway Rd Dallas, TX 75001 • Ph: (972)735-8855 Fx: (972)735-8896 • info@maxilift.com